



Fell Grove, Handsworth
Birmingham, B21 8JQ

£240,000

Handsworth

£240,000



Paul Carr Estate Agents are pleased to offer this three bedroom semi detached family home which is situated on a generous corner plot position with potential to extend with planning consent.

The property comprises of a porch entrance, hallway, spacious open plan lounge / diner, conservatory, wc and fitted kitchen to the ground floor.

The first floor consists of two double bedrooms, a single bedroom and a family bathroom. Ideally located for local amenities, public transport and School catchment.





Property Specification

THREE BEDROOMS
OPEN PLAN LOUNGE / DINER
DOUBLE GLAZING
FITTED KITCHEN
CORNER PLOT POSITION

Porch

Hall

Lounge 3.71m (12'2") x 3.71m (12'2")

Dining Room 4.15m (13'7") x 3.18m (10'5")

Conservatory

Kitchen 2.99m (9'10") x 2.35m (7'9")

WC

Landing

Bedroom One: 3.70m (12'2") x 3.55m (11'8") plus
0.10m (0'4") x 0.10m (0'4")

Bedroom Two: 4.05m (13'3") x 3.60m (11'10")

Bedroom Three: 2.63m (8'8") x 2.19m (7'2")

Bathroom

Agent's Note:

Every care has been taken with the preparation of these Sales Particulars but they are for general guidance only and complete accuracy cannot be guaranteed. If there is any point which is of particular importance, professional verification should be sought. The mention of any fixtures, fittings and/or appliances does not imply they are in full efficient working order as they have not been tested. All dimensions are approximate. Photographs are reproduced for general information and it cannot be inferred that any item shown is included in the sale. These Sales Particulars do not constitute a contract or part of a contract.
Came on the market: 31st May 2021

Viewer's Note:

Services connected: Gas, Electricity, Water Supply & Drainage
Council tax band: C
Tenure: Freehold

Floor Plan

This floor plan is not drawn to scale and is for illustration purposes only

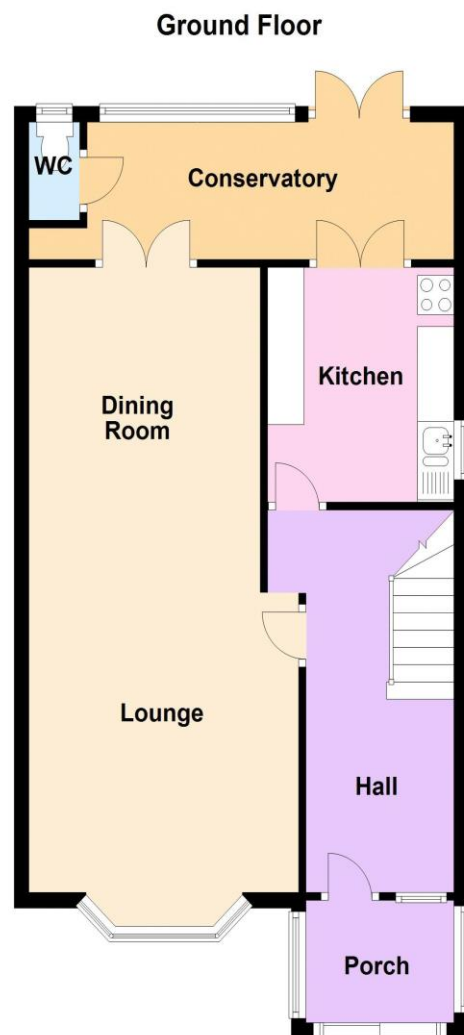

Energy Efficiency Rating

**New
Instruction
Awaiting
E.P.C.**

Map Location

